

elliptipar[®] with LED

Style S141
3" x 5" x 8"



Style S142
3" x 5" x 16"



Style S143
3" x 5" x 21"



SOLVING FOR LIGHT

elliptipar[®]
tambient[®]



THE LIGHTING **QUOTIENT**[™]

www.TheLightingQuotient.com

S141**S142****S143****elliptipar® with LED**your 4-digit Quickfinder code at www.TheLightingQuotient.com

elliptipar... there is no equal

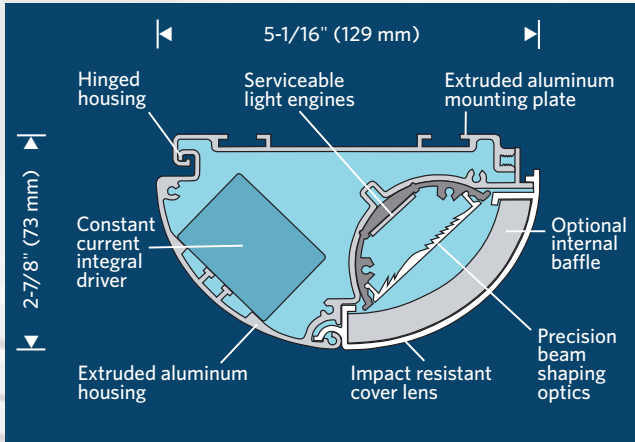
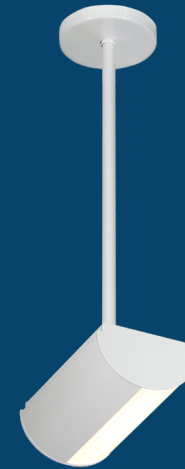
S142**S141 on pendant****S142 on cantilever****S143 on pendant**

- **Small LED asymmetric distribution wall washer** produces an even wash of light on the entire wall without emphasizing surface imperfections
- **Family of three sizes** - **S141** (8-5/16" with 9 LEDs), **S142** (16-5/8" with 18 LEDs) or **S143** (21-1/8" with 27 LEDs)
- **Classic low profile semi-elliptical housing** less than 3" overall height
- **Ideal for** corridors, perimeters, displays, white boards, art walls, menu boards, and in offices, schools and retail
- **Several mountings** - surface, pendant or cantilever
- **Hinged housing with integral driver** - simplifies installation and wiring
- **Up to 3910 lumens delivered** - several lumen packages available based on length, CCT and CRI
- **Excellent lumen maintenance** - L90(10k) > 60,000 hours @ 25°C per TM-21
- **Several CCT/CRI choices** - 2700K, 3000K, 3500K or 4000K in 70+, 80+ or 90+ CRI (other CCT and CRI options are available upon request)
- **Programmable drivers are available** - allows designers to achieve a specific lighting power density or custom light level
- **Easy access** to light engines and drivers for maintenance or future upgrades

SOLVING FOR LIGHTelliptipar®
tambient®THE LIGHTING **QUOTIENT**®

114 Boston Post Road
West Haven, CT 06516
203.931.4455
203.931.4464



© 2017 Sylvan R. Shemitz Designs, LLC

Style S141 1:5 Scale

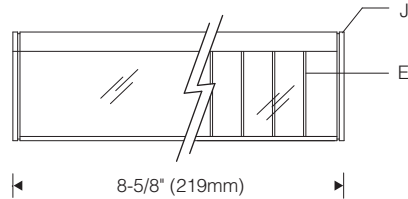
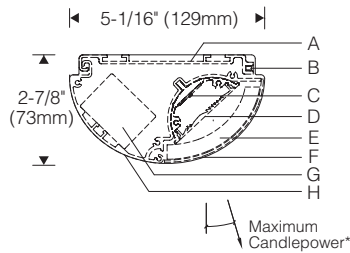

Accessories (X Mount)

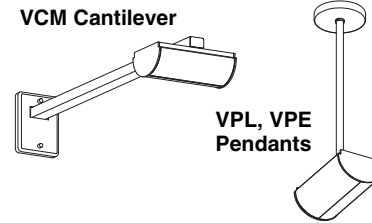

Top View (S Mount) 1:5 Scale

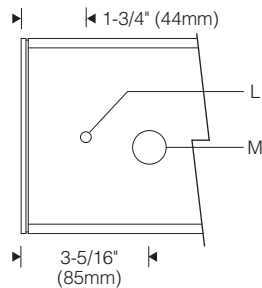

Top View (C Mount) 1:5 Scale

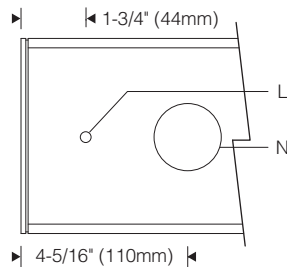

Installation (S mount)

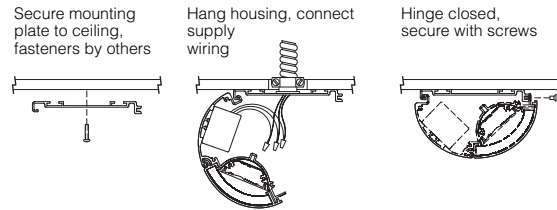

Specifications

- | | | | |
|---|---|---|---|
| A Extruded aluminum mounting plate | D Extruded acrylic beam shaping lens | G High power factor constant current electronic driver | L Mounting hole 9/32" (7mm) diameter |
| B Closure screws | E Optional cross baffle (gray) | H Extruded aluminum housing | M Knockout 7/8" (22mm) diameter |
| C Serviceable light engine | F Extruded acrylic hinging lens | J Aluminum decorative end plates, included | N Access hole to j-box |

Features

- Inconspicuous low profile – lights entire wall evenly without emphasizing surface imperfections (unlike slot grazers)
- Compact size with integral driver
- Asymmetric distribution — evenly lights vertical surfaces
- Light engines serviceable for replacement or future upgrade



Finish:

Painted surfaces – 6 stage pretreatment and electrostatically applied thermoset powder coat for stable, long lasting and corrosion resistant finish. Extruded aluminum mounting plate and housing, formed aluminum end plates. All luminaire hardware – stainless steel.

Optic Assembly:

Light engine – extruded aluminum heat sink with linear array of high power LEDs. Light engines are removable for replacement or upgrade. Precision extruded optical lens of high temperature, water-clear acrylic. Elliptical distribution holographic diffuser maximizes lateral distribution without disturbing asymmetric distribution.

Mounting:

C mount – mounting plate fastens flush to ceiling over recessed outlet box. Unit hinges open for hands-free wiring.

S mount – mounting plate fastens flush to ceiling for direct conduit feed. Unit hinges open for hands-free wiring.

X mount – cantilever arm or pendant stem **ordered separately**.

Pendant stem – 11/16" O.D. aluminum, 5" diameter canopy.
Cantilever arm – 1.5"W x 1"H steel arm, 4.5" x 6" wall canopy.

Electrical:

Use 90°C wire for supply connections. Integral electronic HPF thermally protected Class 2 driver. For complete driver specifications, see website, reference document [MA-1303](#). Driver/wireway compartment includes one conduit entry at each end. Channel cover is removable for access to driver and wiring. Luminaires may be butted end-to-end (connectors by others) for through wiring. Optional electronic dimming driver, compatible dimming controls (by others). See website for dimming compatibility and specifications.

Standard:

UL listed or CSA certified for dry location. 5 year warranty, maximum ambient temperature 45°C (113°F).

Performance

Precisely extruded acrylic lens produces an asymmetric distribution ideal for illuminating vertical surfaces evenly from top to bottom.

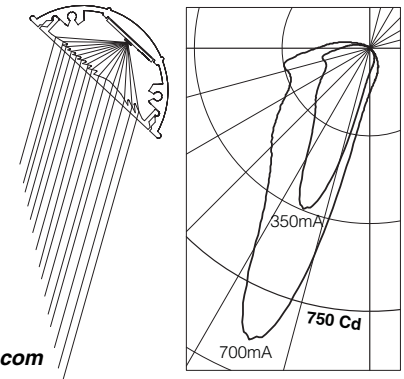

For photometric and lumen maintenance reports, visit thelightingquotient.com

L90(10k) > 60,000 hrs. @ 25°C per TM-21



To form a Catalog Number

S **1 4 1** - | - | - | - | - | - | - | - | - | - | - | - | - | - | - | - |

1 2 3 4 5 6 7 8 9 10

1 Source

S = Solid state (LED)

2 Style

141 = Small enclosed semi-elliptical LED 8" long point source with integral driver

3 Length and Light Output

L009 = 9 LEDs @ 350mA (679 lumens, 10.5 watts)

M009 = 9 LEDs @ 700mA (1232 lumens, 21.0 watts)

Based on 3500K/80+CRI. [Click here](#) for scaled performance table.

4 Mounting

C = Ceiling mount over recessed outlet box

S = Ceiling mount for direct conduit feed

X = For use with cantilever or pendant stem (**ordered separately**)

5 Finish

02 = Semigloss white

22 = Matte white

99 = Custom RAL or computer matched color to be specified, consult factory

6 Voltage/Driver

Electronic Driver

Electronic Dimming Driver**

8 = 120-277V

M = 120-277V

3 = 347V**

K = 347V**

*Not all drivers are available for all voltages and dimming options.

**347V options are available in remote driver only.

Refer to Driver Information document [MA-1303](#)

7 Option (See Accessories Section for specifications)

L0 = Clear lens (included in fixture)

LB = Combination of clear lens and baffle

LM = For use in MRI medical facility (drivers remote mounted). MRI filters (by others) required on output of each remote driver. Consult factory prior to specification.

Project: _____

Type: _____

8 Destination Requirement

0 = UL listed or CSA certified for U.S.

J = UL listed or CSA certified for Canada

9 Color Temperature

27 = 2700K, 80+ CRI **2H** = 2700K, 90+ CRI

30 = 3000K, 80+ CRI **3H** = 3000K, 90+ CRI

35 = 3500K, 80+ CRI

40 = 4000K, 80+ CRI **4L** = 4000K, 70+ CRI

Note: Additional CCT and CRI options are available; consult factory.

10 Dimming**

00 = Non-dimming

TE = LightTech line voltage dimming 100-10% power (trailing edge, reverse phase, ELV dimming controls by others)

ZX = 0-10V analog dimming 120-277V or 347V input (347V with remote driver only), dimming range 100%-5%, 0-10V controls by others

EL = eldoLED SOLOdrive 120-277V input, 0-10V analog gamma corrected dimming 100%-0.1% power (controls by others)

ED = eldoLED SOLOdrive 120-277V input, dimming range 100%-0.1%, DALI controls by others

Remote Mounted Driver Options:

L2 = Lutron Hi-lume LTE 120V input only, dimming range 100%-1%, compatible 2-wire dimming controls by others

LH = Lutron Hi-lume L3D 120-277V input, dimming range 100%-1%, Lutron 3-wire dimming controls by others

L3 = Lutron Hi-lume L3D EcoSystem 120-277V input, dimming range 100%-1%, EcoBus dimming controls by others

**Dimming range refers to % power input, % light output will vary.

Refer to Driver Information document [MA-1303](#)

Note: Number of drivers varies with number of LEDs, drive current and driver type.

Accessories

Order separately. See Accessories Section for specifications.

VCM _____ | 30 _____ = **Cantilever**, 30" (760mm) setback
 0 = U.S.
 J = Canada

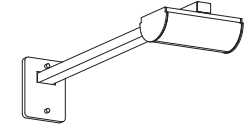

5 Finish

VP _____ | _____ | _____ = **Wallwash pendant**
 0 = U.S.
 J = Canada



Length in inches
(54" (1.4m) maximum)

5 Finish

L = Straight

E = Swivel (up to 45°)

AMR02050 = Accessory Magnetic Resonance imaging filter. 2 conductor up to 5 amps, attenuation > 100dB (5MHz to 10GHz)

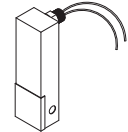

Note: one filter required per remote driver – consult factory for number of drivers required per luminaire.



elliptipar by The Lighting Quotient

LED lighting facts
A Program of the U.S. DOE

Light Output (Lumens)	1232
Watts	21
Lumens per Watt (Efficacy)	58.67
Color Accuracy Color Rendering Index (CRI)	80
Light Color Correlated Color Temperature (CCT)	3500 (Bright White)
Warranty**	Yes

All results, except LED Lumen Maintenance, are according to IESNA LM-79-2008: Approved Method for the Electrical and Photometric Testing of Solid-State Lighting. The U.S. Department of Energy (DOE) verifies product test data and results.

**** See www.lightingfacts.com/products for details.**

Registration Number: 3HVJ-JPQWBL (3/9/2016)
 Model Number: S141-M009-**-LG-1-35-00
 Type: Luminaire - Wallwash



elliptipar from The Lighting Quotient
 114 Boston Post Road, West Haven, Connecticut 06516, USA
 Voice 203.931.4455 • Fax 203.931.4464 • [thelightingquotient.com](#)

Certain products illustrated may be covered by applicable patents and patents pending. These specifications supersede all prior publications and are subject to change without notice. Copyright © 2017 Sylvan R. Shemitz Designs, LLC, all rights reserved.

Style S142 1:5 Scale

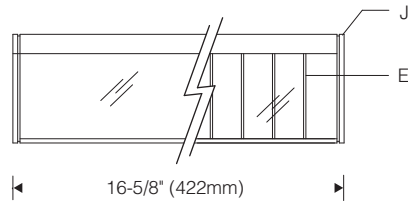
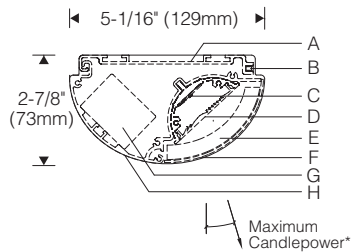

Accessories (X Mount)

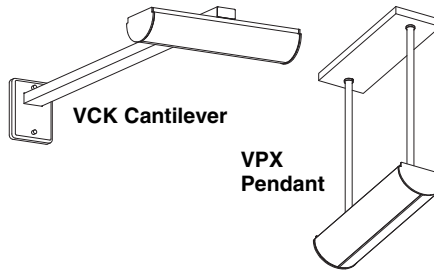

Top View (S Mount) 1:5 Scale

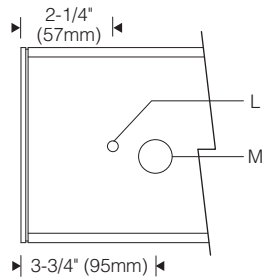

Top View (C Mount) 1:5 Scale

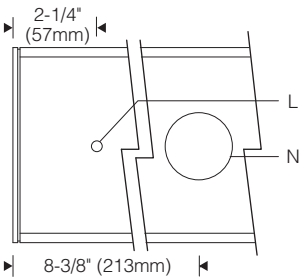

Installation (S mount)

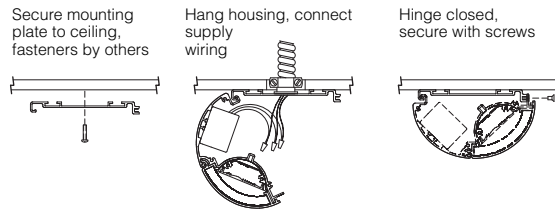

Specifications

- | | | | |
|---|---|---|---|
| A Extruded aluminum mounting plate | D Extruded acrylic beam shaping lens | G High power factor constant current electronic driver | L Mounting hole 9/32" (7mm) diameter |
| B Closure screws | E Optional cross baffle (gray) | H Extruded aluminum housing | M Knockout 7/8" (22mm) diameter |
| C Serviceable light engine | F Extruded acrylic hinging lens | J Aluminum decorative end plates, included | N Access hole to j-box |

Features

- Inconspicuous low profile – lights entire wall evenly without emphasizing surface imperfections (unlike slot grazers)
- Compact size with integral driver
- Asymmetric distribution — evenly lights vertical surfaces
- Light engines serviceable for replacement or future upgrade



Finish:

Painted surfaces – 6 stage pretreatment and electrostatically applied thermoset powder coat for stable, long lasting and corrosion resistant finish. Extruded aluminum mounting plate and housing, formed aluminum end plates. All luminaire hardware – stainless steel.

Optic Assembly:

Light engine – extruded aluminum heat sink with linear array of high power LEDs. Light engines are removable for replacement or upgrade. Precision extruded optical lens of high temperature, water-clear acrylic. Elliptical distribution holographic diffuser maximizes lateral distribution without disturbing asymmetric distribution.

Mounting:

C mount – mounting plate fastens flush to ceiling over recessed outlet box. Unit hinges open for hands-free wiring.

S mount – mounting plate fastens flush to ceiling for direct conduit feed. Unit hinges open for hands-free wiring.

X mount – cantilever arm or pendant stems **ordered separately**.
Pendant stems – 11/16" O.D. aluminum, 5" x 15" ceiling canopy.
Cantilever arm – 2"W x 1"H steel arm, 4.5" x 6" wall canopy.

6/17

U.S. Patent D459,012. Canadian Patent 93426.

Electrical:

Use 90°C wire for supply connections. Integral electronic HPF thermally protected Class 2 driver. For complete driver specifications, see website, reference document [MA-1303](#). Driver/wireway compartment includes one conduit entry at each end. Channel cover is removable for access to driver and wiring. Luminaires may be butted end-to-end (connectors by others) for through wiring. Optional electronic dimming driver, compatible dimming controls (by others). See website for dimming compatibility and specifications.

Standard:

UL listed or CSA certified for dry location. 5 year warranty, maximum ambient temperature 45°C (113°F).

Performance

Precisely extruded acrylic lens produces an asymmetric distribution ideal for illuminating vertical surfaces evenly from top to bottom.

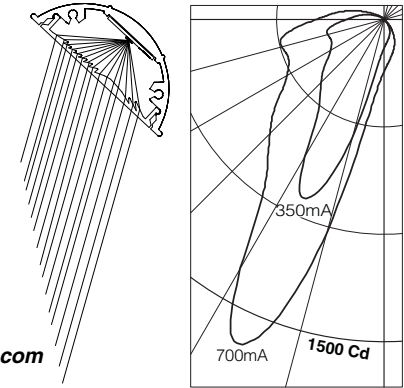

For photometric and lumen maintenance reports, visit thelightingquotient.com

L90(10k) > 60,000 hrs. @ 25°C per TM-21



Style S143 1:5 Scale

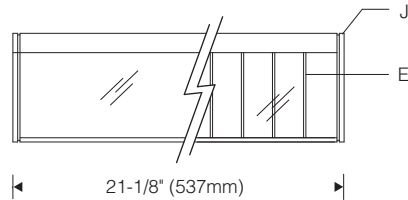
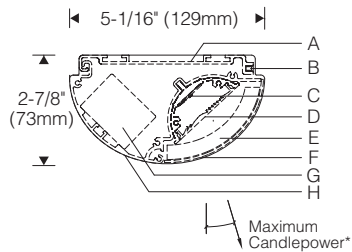

Accessories (X Mount)

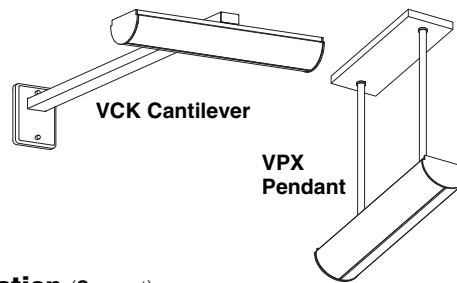

Top View (S Mount) 1:5 Scale

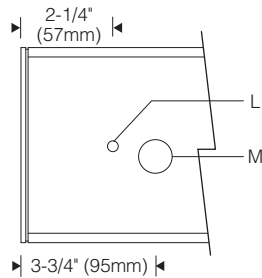

Top View (C Mount) 1:5 Scale

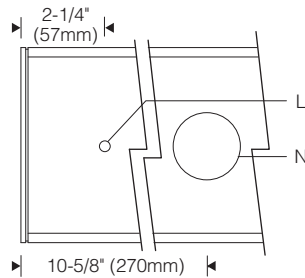

Installation (S mount)

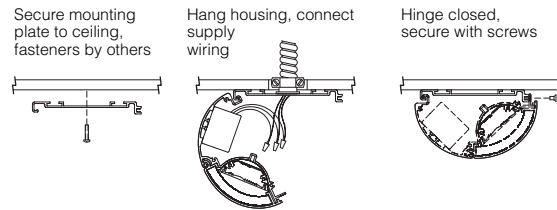

Specifications

- | | | | |
|---|---|---|---|
| A Extruded aluminum mounting plate | D Extruded acrylic beam shaping lens | G High power factor constant current electronic driver | L Mounting hole 9/32" (7mm) diameter |
| B Closure screws | E Optional cross baffle (gray) | H Extruded aluminum housing | M Knockout 7/8" (22mm) diameter |
| C Serviceable light engine | F Extruded acrylic hinging lens | J Aluminum decorative end plates, included | N Access hole to j-box |

Features

- Inconspicuous low profile – lights entire wall evenly without emphasizing surface imperfections (unlike slot grazers)
- Compact size with integral driver
- Asymmetric distribution — evenly lights vertical surfaces
- Light engines serviceable for replacement or future upgrade



Finish:

Painted surfaces – 6 stage pretreatment and electrostatically applied thermoset powder coat for stable, long lasting and corrosion resistant finish. Extruded aluminum mounting plate and housing, formed aluminum end plates. All luminaire hardware – stainless steel.

Optic Assembly:

Light engine – extruded aluminum heat sink with linear array of high power LEDs. Light engines are removable for replacement or upgrade. Precision extruded optical lens of high temperature, water-clear acrylic. Elliptical distribution holographic diffuser maximizes lateral distribution without disturbing asymmetric distribution.

Mounting:

C mount – mounting plate fastens flush to ceiling over recessed outlet box. Unit hinges open for hands-free wiring.

S mount – mounting plate fastens flush to ceiling for direct conduit feed. Unit hinges open for hands-free wiring.

X mount – cantilever arm or pendant stems **ordered separately**.

Pendant stems – 11/16" O.D. aluminum, 5" x 15" ceiling canopy.

Cantilever arm – 2"W x 1"H steel arm, 4.5" x 6" wall canopy.

6/17

U.S. Patent D459,012. Canadian Patent 93426.

Electrical:

Use 90°C wire for supply connections. Integral electronic HPF thermally protected Class 2 driver. For complete driver specifications, see website, reference document [MA-1303](#). Driver/wireway compartment includes one conduit entry at each end. Channel cover is removable for access to driver and wiring. Luminaires may be butted end-to-end (connectors by others) for through wiring. Optional electronic dimming driver, compatible dimming controls (by others). See website for dimming compatibility and specifications.

Standard:

UL listed or CSA certified for dry location. 5 year warranty, maximum ambient temperature 45°C (113°F).

Performance

Precisely extruded acrylic lens produces an asymmetric distribution ideal for illuminating vertical surfaces evenly from top to bottom.

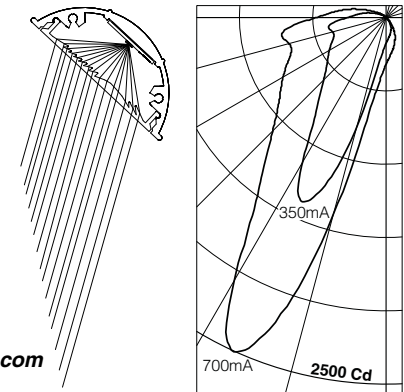

For photometric and lumen maintenance reports, visit thelightingquotient.com

L90(10k) > 60,000 hrs. @ 25°C per TM-21



