

S Mount: 1:12 Scale

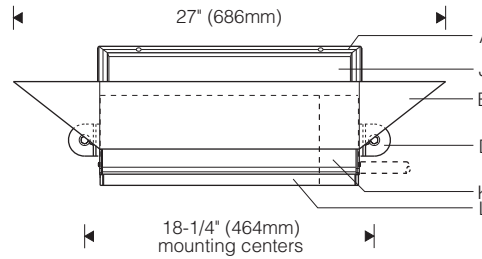

W Mount: 1:12 Scale

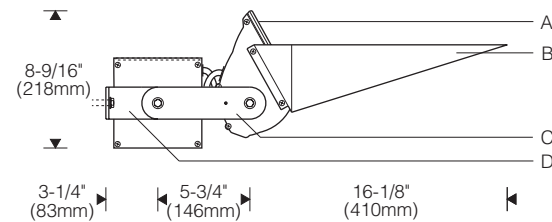
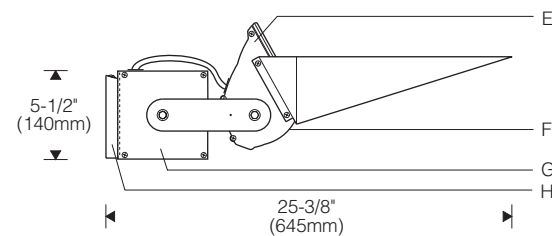

Mounting Plate (W mount, wall only)

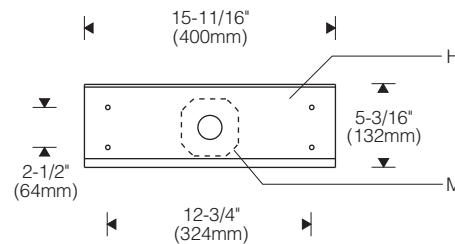

Specifications

- | | | | |
|---|---|--|--|
| A Mitred extruded aluminum door with silicone gasket | D Aluminum mounting feet | H Stainless steel latch/hinge mounting plate (black) | K Internal splice compartment (S mount) |
| B Formed aluminum flared cutoff visor | E Contoured aluminum end plates | J Clear, flat, thermal and impact resistant tempered glass lens | L Extruded aluminum ballast housing |
| C Die-cast side arms | F Specular extruded aluminum reflector | | M Recessed outlet box (by others) |
| | G Die-cast end plates | | |

Finish:

Exterior surfaces – 6 stage pretreatment and electrostatically applied thermoset polyester powder coating for a durable abrasion, fade and corrosion resistant finish. Choice of semi-gloss colors (see ordering information).

Reflector and internal end plates – extruded high purity aluminum with clear anodized specular finish. All hardware and components – non-corrosive stainless steel or aluminum. Door secured with captive tamper-resistant (#10 Torx) screws in stainless steel threaded reflector inserts to prevent seizing.

Mounting:

S mount – L-shaped mounting feet attach under sidearms. 13/32" dia. (10mm) clearance holes (3/8" fasteners by others).

W mount – latch/hinge mounting plate fastens over recessed outlet box and allows hands-free access to splices (1/4" fasteners by others). For wall mounting only.

Suitable backing structure required (by others).

Standard:

Suitable for protected outdoor locations such as parking garages and under canopies. Reflector is sealed for wash-down. UL listed or CSA certified for damp locations.

REV. 8/08

Electrical:

Use 90°C wire for supply connections.

S mount – internal splice compartment with two 1/2" NPT entries (right end plate when facing lens; conduit and fittings by others).

W mount – latch/hinge mounting plate allows hands free access to splices in recessed outlet box (by others). Lamp leads exit reflector and enter ballast housing through watertight flush cord entries and silicone coated fiberglass sleeving.

Mogul lampholder is pulse rated for use with either horizontal or universal position reduced envelope pulse start lamps. End-of-lamp aligner ensures consistent optical performance, minimizes damage from shock or vibration.

Ballast – integral HPF constant wattage autotransformer (CWA) or electronic each rated for -20°F/-29°C starting.

For complete ballast specifications, see Accessories Section.

Features

- Unique asymmetric performance – creates expansive planes of light to eliminate glare and minimize shadows
- Mounting flexibility – wall plate over J-box or mounting feet with surface conduit
- Built to last – all aluminum and stainless steel components; tempered glass lens, tamper-resistant door screws

Performance

Two parabolic reflector sections drive light across the overhead plane from one edge. An elliptical section redirects its light to a parabola and shields the lamp. Asymmetry is maximized resulting in high beam efficiency and superior surface uniformity. The fast "runback" minimizes wasted spill light. Wide lateral distribution permits greater spacings.

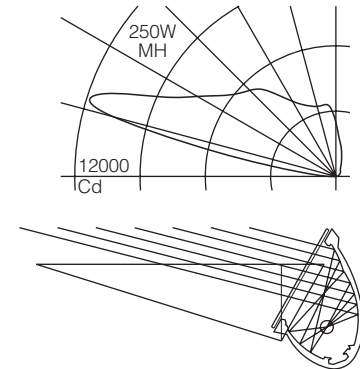

For complete photometrics, see www.elliptipar.com.

elliptipar



To form a Catalog Number

M | 4 | 5 | 6 | - | - | - | - | F | | |
 1 | 2 | 3 | 4 | 5 | 6 | 7 | 8





1 Source

M = Metal halide

2 Style

456 = Large garage uplight, contoured reflector, integral ballast

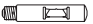
3 Lamp

Lamp Code	Watt-age	Lamp Number	Volt-ages
Ceramic Arc Tube Pulse Start Metal Halide (90+ CRI) 			
210C	210	CDM210/T9/930/U/E	2, U
315C	315	CDM315/T9/930/U/E	2, U
Ceramic Arc Tube Pulse Start Metal Halide (80+ CRI)*  			
150G	150	CDM150/T6/830	1, 2 T, U
250C	250	CMH250/U/830/R	A, B
400C	400	CMH400/U/830/R	A, B
Quartz Arc Tube Pulse Start Metal Halide (68 CRI)* 			
250P	250	MS 250W/H75/T15/PS/740	A, B 2, U
320P	320	MS 320W/H75/T15/S/PS/740	A, B 2, U
350P	350	MS 350W/H75/T15/PS/740	A, B 2, U

For complete lamp and ballast information, see Accessories Section.

* Use only clear metal halide horizontal or universal position lamp with compact envelope. Standard lamp colors are 3000K for Ceramic Arc Tube Pulse Start lamps and 4000K for Quartz Arc Tube Pulse Metal Halide lamps.

4 Mounting

S = L-shaped feet for surface mounting. Internal splice compartment with (2) 1/2" NPT threaded entries.
 W = Latch/hinge wall plate fastens over recessed outlet box (by others).

Project: _____

Type: _____

5 Finish

02 = Semi-gloss white
 06 = Dark bronze
 07 = Silver
 08 = Semi-gloss black
 12 = Green
 99 = Custom RAL or computer matched color to be specified, consult sales representative.

6 Voltage/Ballast

Electronic:

1 = 120V
 2 = 277V
 T = 120V dim*
 U = 208-277V dim*

Magnetic:

A = 120V
 B = 277V

*100-50% dimming, 0-10V compatible controls by others. Consult factory for dimming the 210W lamp.

7 Option (See Accessories Section for specifications)

F0 = Flared cutoff visor included, no other options.
 FR = Halogen standby lighting with relay.
 FL = Micro-prismatic tempered glass lens (replaces clear flat lens, offers smoother light pattern at reduced peak candlepower).
 FX = For modification not listed, include detailed description.
Note: Flared cutoff visor included with all options.

8 Destination Requirement

0 = UL listed or CSA certified for U.S.
 J = UL listed or CSA certified for Canada

Example

M456 - 250C - S - 02 - B - F00

Large contoured garage uplight for use with 250 watt ceramic arc tube pulse start metal halide lamp (included). Surface mounted on wall with L-shaped feet. Internal splice compartment (liquidtight conduit and fittings by others). Semi-gloss white. Integral 277V ballast. UL listed or CSA certified for U.S. Flared cutoff visor included.

Accessories

Order separately. See Accessories Section for specifications.

AEDV20D0 = External vertical blade **baffle**, 25° (offers lengthwise shielding from adjacent raised viewpoint e.g. stairs)

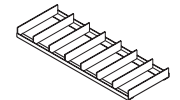

AFK000X | = Ballast fuse kit
 0 = U.S.
 J = Canada

