

Style 3030 1:8 Scale

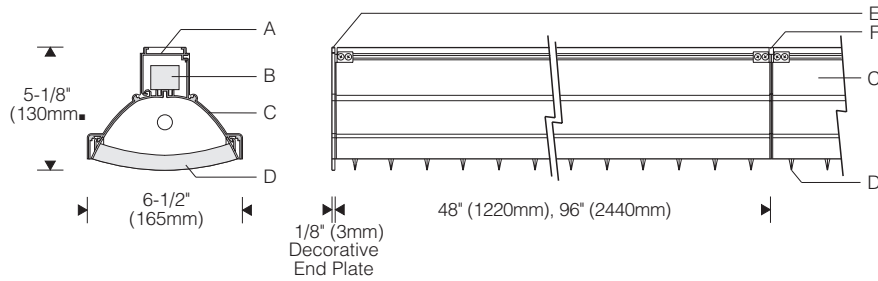

Top View (S mount)

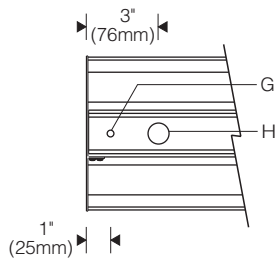

Installation (S mount)

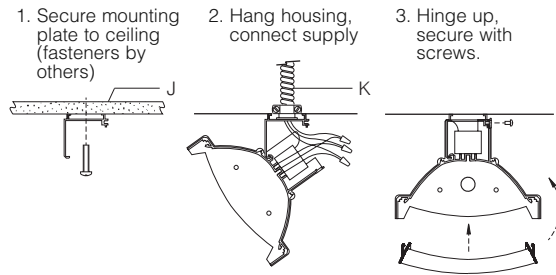

Pendant Stems (X mount)

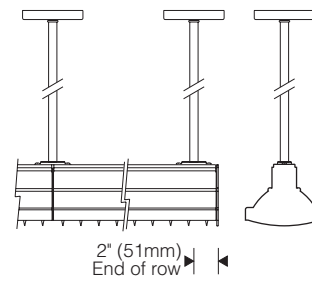

Cables (X mount)

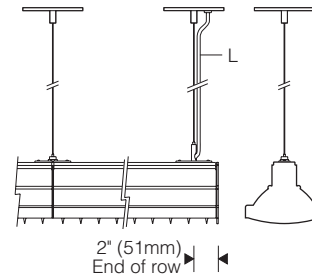

Specifications

- | | | | |
|---|--|---|---|
| A Extruded aluminum mounting plate | D Snap-in semi-specular parabolic cross-baffle, blades 1-1/2" o.c., 25° shielding | G Mounting holes, 9/32" (7mm) dia. (S mount) | K Conduit, connector (by others) |
| B Electronic ballast | E Aluminum decorative end plate (3 profiles – order separately) | H Knockout, (2) 7/8" (22mm) dia. (S mount) | L 18/4 cord with cable clips (cable mount) |
| C Specular extruded aluminum reflector housing | F Aluminum joiner/reveal plates | J Structure, fasteners (by others) | |

Finish:

Semi-gloss white or bright clear anodized aluminum housing with semi-gloss white or black reveal plates. White or silver decorative end plates (order separately).
Painted surfaces – 6 stage pretreatment and electrostatically applied thermoset powdercoat for stable, long lasting finish.
Reflector – extruded high purity aluminum with clear anodized specular finish. All luminaire hardware – stainless steel.
Cross-baffle – injection molded high-impact polycarbonate with metalized semi-specular finish.

Mounting:

S mount – mounting plate fastens flush to ceiling. Unit hinges on plate for hands-free access to wiring.
X mount – pendant stems, cables **ordered separately**.
Pendant stem – 11/16" O.D. aluminum, internally threaded. 5" dia. aluminum canopy.
Cable – 1/16" dia. 7x7 aircraft cable, field adjustable length.
Crossbar with 1/4-20 stud and 5" dia. canopy.
For shelf supported bridge or cantilever, consult factory.

Electrical:

Use 90°C wire for supply connections and through wire.
S mount – 7/8" (22mm) dia. knockouts at ends of mounting plate for conduit feed (by others).
X mount – electrical feed hanger mounts over recessed outlet box (by others) and **must be located at end of row**. Housing hinges down for access to ballast and wiring. Optional #12 AWG prewired modular through wiring with quick connectors.
Integral electronic HPF thermally protected class P ballast with end-of-life protection.
Optional integral emergency battery operates one lamp. Separate unswitched supply is required.
Optional integral motion sensor, consult factory.

Standard:

UL listed or CSA certified.

Features

- Exceeds IESNA recommended light level – 30fc vertical at 30" AND complies with energy standards (T5)
- Precise extruded reflector drives light to the bottom shelf – maximizes visibility of books and shelf utilization
- Innovative variable width cross-baffle – redirects wasted light
- Optional emergency battery; motion sensor (consult factory)

Performance

Multiple reflector segments drive light to the lowest shelves. Unique cross-baffle redirects a portion of the lamp energy that otherwise goes directly to the floor back into the main beam while providing lengthwise shielding. The result is high beam efficiency and superior surface uniformity in tall, narrow stacks.

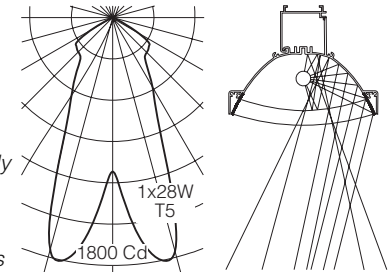

For complete photometrics, visit thelightingquotient.com



Cradle to Cradle Certified^{CM} is a certification mark licensed by the Cradle to Cradle Products Innovation Institute.



To form a Catalog Number

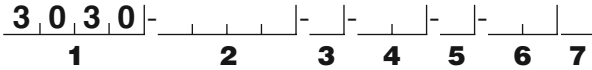

1 Style

3030 = Stack light, integral ballast

2 Lamp

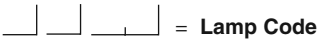

Lamp Wattage (see chart below)

Number of Lamps in Length, specify 1 or 2

A = T8 Fluorescent Example: **T228** = 8' (2.4m) housing with two 28W T5 lamps (end-to-end)
 T = T5 Fluorescent

Length*	T5		T8	
	Code	Lamp(s)	Code	Lamp(s)
Linear Fluorescent				
36" (915mm)	T121	1 x F21T5	A125	1 x F25T8
48" (1220mm)	T128	1 x F28T5	A132	1 x F32T8
72" (1830mm)	T221	2 x F21T5	A225	2 x F25T8
96" (2440mm)	T228	2 x F28T5	A232	2 x F32T8

For complete lamp and ballast information, see Accessories Section. Standard T5 lamp color is 3000K/80+ CRI. *Add 1/4" (6mm) to row or single unit for **ADE** Decorative End Plates.

3 Mounting

S = Ceiling (surface) mount
 X = For use with pendant stem or cable hangers

Note: Order hangers separately

For shelf supported bridge or cantilever mount, consult factory.

4 Finish

01 = Bright clear anodized reflector with black reveals (matching **ADE** end plates are silver – order separately)
 02 = Semi-gloss white (matching **ADE** end plates are white – order separately)
 99 = Custom RAL or computer matched color to be specified, consult sales representative

5 Voltage/Ballast

Electronic

1 = 120V
 2 = 277V
 3 = 347V (Canada)

Project: _____

6 Option (See Accessories Section for specifications)

00 = No option
 0E = Integral emergency battery pack with indicator lamp and test button. Operates one lamp. Not for use with 2ft and 3ft units.
 0K = Prewired modular #12 AWG through wiring with quick connectors
 EK = Combination emergency battery and modular thru wire. Not for use with 2ft and 3ft units.
 XX = For modification not listed, include detailed description. Consult factory prior to specification.

7 Destination Requirement

0 = UL listed or CSA certified for U.S.
 J = UL listed or CSA certified for Canada

Example

3030 - T228 - S - 02 - 1 - 0E0

Stack light for use with two 4' F28T5 lamps. 96" long housing (not including decorative end plates). Ceiling (surface) mount. Semi-gloss white. Integral 120V electronic 2-lamp ballast. UL listed or CSA certified for U.S. Optional battery pack. Order decorative end plates separately.

Accessories

Order separately. See Accessories Section for specifications.

ADE _____ **0** = Decorative end plates, pair, silver, white, or custom color to match housing.
4 = _____
 Note: required for each row or single unit. Adds 1/4" (6mm) to length.

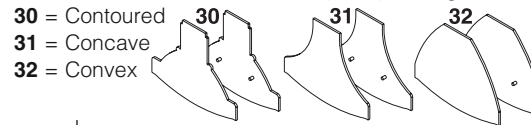

AFK000X _____ = Ballast fuse kit
0 = U.S.
J = Canada

AMU = Modular **uplight**, low-profile symmetrical reflector piggy-backed on top of mounting plate. For use with X mount stem or cable only. May be switched separately.
 Note: Consult factory for complete specifications and ordering information.

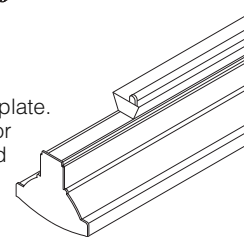

AOS = Accessory Occupancy Sensor (consult factory for complete specifications and ordering information).

Type: _____

Hangers

Order separately. See Accessories Section for specifications. Singles – order one non-electrical and one electrical feed hanger for each unit (**X** mount).

Rows – order one non-electrical hanger for each unit (**X** mount) plus one electrical feed for each row.

Electrical feed(s) must be located at an end of row.

VE _____ **0** = Pendant stem, 11/16" O.D.
 Length in inches, up to 60" (1.5m), 6" minimum

01 = Silver canopy & stem
02 = White canopy & stem
99 = Custom RAL or computer matched color to be specified

F = Non-electrical
G = Electrical feed, with (4) #14 AWG leads

Length, ceiling to top of housing

VE _____ **0** = Cable support, field adjustable
48 = up to 48" (1.2m)
96 = up to 96" (2.4m)

02 = White canopy
99 = Custom RAL or computer matched color to be specified

R = Non-electrical
S = Electrical feed, 18/4 metal braid cord

VC3 _____ **XX** _____ = Cantilever, for stack mounting, two shown below
0 = U.S.
J = Canada
XX = Consult factory for complete specifications and ordering information

02 = Semi-gloss white
07 = Silver
08 = Semi-gloss black
99 = Custom/special finish

Certain products illustrated may be covered by applicable patents and patents pending. These specifications supersede all prior publications and are subject to change without notice. Copyright © 2012 Sylvan R. Shemitz Designs, Inc., all rights reserved.