

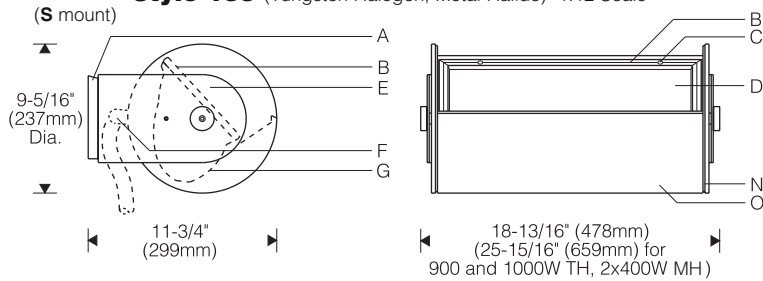

**Style 153** (Tungsten Halogen, Metal Halide) 1:12 Scale

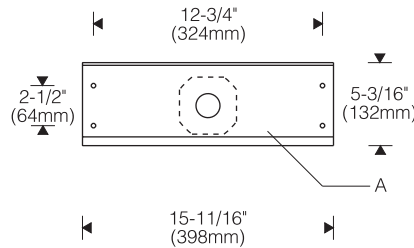

**Mounting Plate**



**Style 154** (Metal Halide) 1:12 Scale

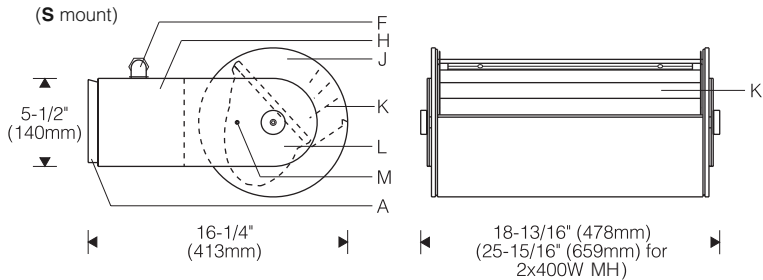

**Installation**

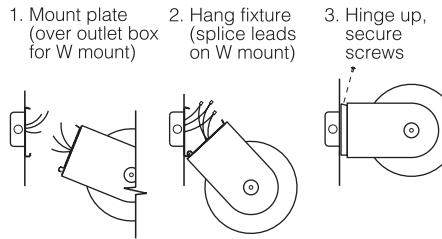

**Specifications**

- |   |  |  |   |
|---|--|--|---|
| <b>A</b> Stainless steel latch/hinge mounting plate (black)       | <b>D</b> Clear, flat, thermal and impact resistant tempered glass lens | <b>G</b> Specular extruded aluminum reflector            | <b>L</b> 3/16" aluminum side arms                           |
| <b>B</b> Mitred extruded aluminum door frame with silicone gasket | <b>E</b> 3/16" aluminum yoke   | <b>H</b> Extruded ballast housing                        | <b>M</b> Locking set screw                                  |
| <b>C</b> Tamper resistant captive door screws                     | <b>F</b> 3/8" liquidtight connector (S mount only, conduit by others)  | <b>J</b> 1/4" aluminum end plates                        | <b>N</b> Aluminum reveal plates with drainage slots (black) |
|   |  | <b>K</b> Optional horizontal radial blade baffle (black) | <b>O</b> Extruded aluminum cylindrical housing              |

**Finish:**

Exterior surfaces – 6 stage pretreatment and electrostatically applied thermoset polyester powder coating for a durable abrasion, fade and corrosion resistant finish. Choice of semi-gloss colors (see ordering information).

Reflector and internal end plates – extruded high purity aluminum with clear anodized specular finish. All hardware and components – non-corrosive stainless steel or aluminum. Door secured with captive tamper-resistant (#10 Torx) screws in stainless steel threaded reflector inserts to prevent seizing. Yoke/sidearms attach with recessed hex socket screws.

**Mounting:**

Stainless steel latch/hinge mounting plate. Suitable backing structure required (by others).

**S** mount – wall or base mounted for use with exposed liquidtight conduit (by others).

**W** mount – wall mounted over recessed outlet box (by others). Fixture hinges on mounting plate for hands-free splice access.

1-way or 2-way pendant assembly ordered separately for Style 153 units; specify **X** mount. Ballast(s) are integral to pendant.

**Electrical:**

Use 90°C wire for supply connections. **S** mount supplied with 5' (1.5m) leads exposed beyond 3/8" 90° liquidtight conduit connector (provided). **W** mount has 8" (.2m) leads.

Tungsten halogen (Style 153 only) – recessed single contact (RSC) lampholders in patented clamping supports for maximum heat dissipation.

Metal halide – Mogul lampholder is pulse rated for use with either horizontal or universal position reduced envelope pulse start lamps. End-of-lamp aligner ensures consistent optical performance, minimizes damage from shock or vibration. Ballast – remote HPF constant wattage autotransformer (CWA) or electronic each rated for -20°F/-29°C starting. Weatherproof aluminum enclosure (Style 153) includes three 7/8" diameter entries and one 3/8" liquidtight conduit connector. Optional remote ballast for dry indoor location.

For complete ballast specifications, see Accessories Section.

**Standard:**

UL listed or CSA certified for wet locations.

**Features**

- Rugged extruded aluminum cylinder with 1/4" end plates houses the rigid reflector – no exposed fasteners
- Suitable for upward facing operation – watertight reflector, concealed slots in cylindrical housing for drainage
- Round end plates – consistent profile regardless of aiming
- Powerful – up to 1000W halogen, 2X400W metal halide



**Performance**

Two parabolic reflector sections drive light across the overhead plane from one edge. An elliptical section redirects its light to a parabola and shields the lamp. Asymmetry is maximized resulting in high beam efficiency and superior surface uniformity. The fast "runback" minimizes wasted spill light. Wide lateral distribution permits greater spacings.

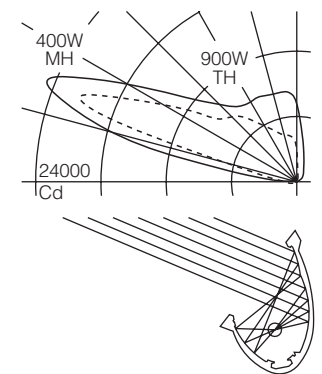

For complete photometrics, visit [thelightingquotient.com](http://thelightingquotient.com)

To form a Catalog Number

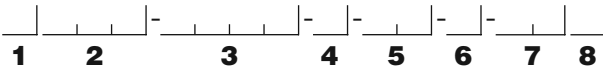

1 Source

M = Metal halide  
T = Tungsten halogen

2 Style

153 = Large outdoor cylinder, remote ballast (TH, MH)  
154 = Large outdoor cylinder, integral ballast (MH)

3 Lamp

Lamp Code	Wattage	Lamp Number	Voltages	Remote Distance
Ceramic Arc Tube Pulse Start Metal Halide (90+ CRI)				
210C	210	CDM210/T9/930/U/E	2, U	30' (9m)
315C	315	CDM315/T9/930/U/E	2, U	30' (9m)
Ceramic Arc Tube Pulse Start Metal Halide (80+ CRI)*				
150G	150	CDM150/T6/830	1, 2 T, U	15' (4.5m) 5' (1.5m)
250C	250	CMH250/U/830/R	A, B	50' (15m)
400C	400	CMH400/U/830/R	A, B	50' (15m)
240C	2x400	(2) CMH400/U/830/R	A, B	50' (15m)
Quartz Arc Tube Pulse Start Metal Halide (68 CRI)*				
250P	250	MS 250W/H75/T15/PS/740	A, B 2, U	50' (15m) 16' (4.8m)
320P	320	MS 320W/H75/T15/S/PS/740	A, B 2, U	50' (15m) 16' (4.8m)
350P	350	MS 350W/H75/T15/PS/740	A, B 2, U	50' (15m) 16' (4.8m)
Tungsten Halogen				
0300	300	Q300T3	A	
0350	350	Q350T3/CL/HIR	A	
0500	500	Q500T3	A	
0900	900	Q900T3/CL/HIR	B, G	
1000	1000	Q1000T3	F, G	

For complete lamp and ballast information, see Accessories Section.  
\* Use only clear metal halide horizontal or universal position lamp with compact envelope. Standard lamp colors are 3000K for Ceramic Arc Tube Pulse Start lamps and 4000K for Quartz Arc Tube Pulse Metal Halide lamps.

Project: \_\_\_\_\_

4 Mounting

W = Latch/hinge mounting plate fastens over recessed outlet box. Wall mounting only.  
S = Latch/hinge mounting plate for base or wall. For use with exposed liquidtight conduit (by others).  
X = For use with 1-way or 2-way upright pendant assembly (order separately). Style 153 units only.

5 Finish

02 = Semi-gloss white  
06 = Dark bronze  
07 = Silver  
08 = Semi-gloss black  
12 = Green  
99 = Custom RAL or computer matched color to be specified, consult sales representative.

6 Voltage/Ballast

Electronic (Metal Halide only):  
1 = 120V  
2 = 277V  
T = 120V dim\*  
U = 208-277V dim\*  
Magnetic and Tungsten Halogen:  
A = 120V  
B = 277V  
F = 220V (TH)  
G = 240V (TH)  
\*100-50% dimming, 0-10V compatible controls by others. Consult factory for dimming the 210W lamp.

7 Option (see Accessories Section for specifications)

00 = No options  
0B = Internal horizontal radial blade baffle, matte black. Provides horizontal cutoff of lens brightness when maximum candlepower is aimed 35° above horizontal.  
0R = Halogen standby lamp with relay. Relay is field connected at remote ballast for Style 153, integral for Style 154. Lamp included (wattage varies). Not available for 2x400W.  
TL = Micro-prismatic tempered glass lens (replaces clear, flat lens, offers smoother light pattern at reduced peak candlepower).  
XX = For modification not listed, include detailed description. Consult factory prior to specification.

8 Destination Requirement

0 = UL listed or CSA certified for U.S.  
J = UL listed or CSA certified for Canada

Type: \_\_\_\_\_

Example

M154 - 400C - S - 02 - B - 0D0

Large outdoor cylinder for use with 400 watt ceramic arc tube pulse start metal halide lamp. Latch/hinge mounting plate for use with exposed liquidtight conduit (by others). Semi-gloss white powder coat finish. Remote dry indoor 277V ballast. UL listed or CSA certified for U.S.

Accessories

Order separately. See Accessories Section for specifications.

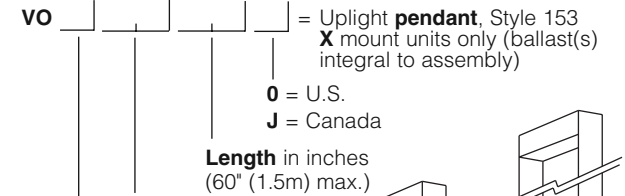

5 Finish

D = 1-way assembly for 300W-500W TH; 150W-400W MH  
E = 2-way assembly for 300W-500W TH; 150W-400W MH  
F = 1-way assembly for 900 and 1000W TH; 2x400W MH  
G = 2-way assembly for 900 and 1000W TH; 2x400W MH

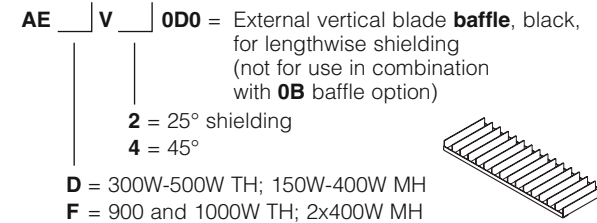

D = 300W-500W TH; 150W-400W MH  
F = 900 and 1000W TH; 2x400W MH

