

Style 147 1:8 Scale

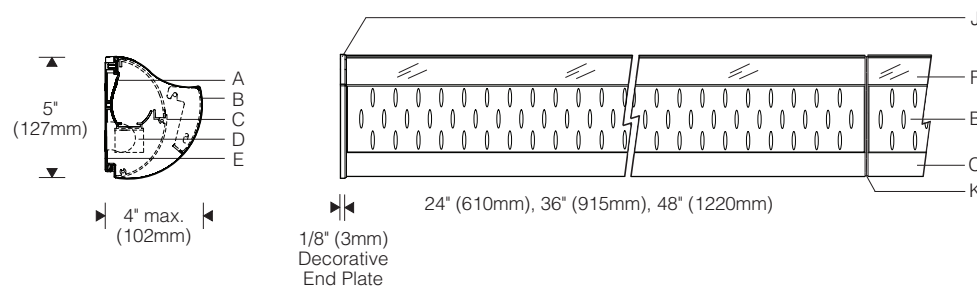

Mounting Plate 1:8 Scale

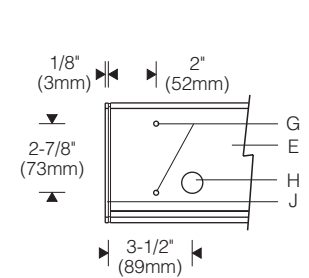

Installation

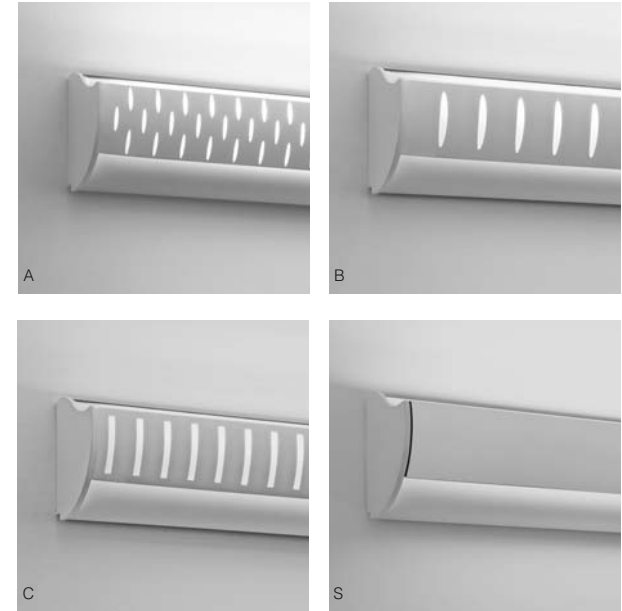
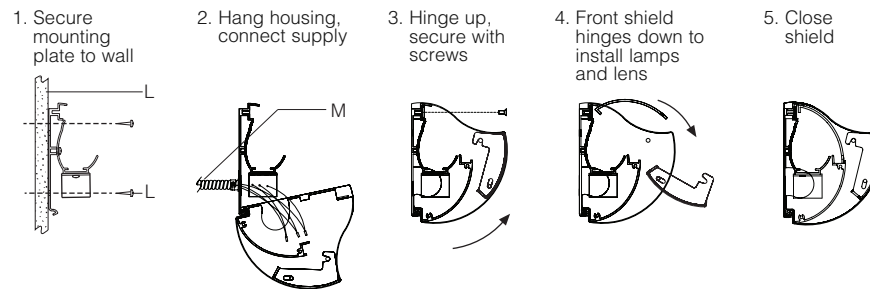

Specifications

- | | | | |
|---|---|--|--|
| A Specular extruded aluminum reflector | D Electronic ballast | G Mounting holes, 9/32" (7mm) dia. | K Aluminum joiner/reveal plates (white) |
| B Decorative illuminated glowing front shield or solid non-illuminated | E Extruded aluminum mounting plate | H Conduit entry, (2) 7/8" (22mm) dia. | L Structure and fasteners (by others) |
| C Extruded aluminum housing | F Clear UV resistant acrylic lens | J Aluminum decorative end plates (order separately) | M Conduit and connector (by others) |

Features

- ADA compliant – ideal for hospital and school corridors
- Xtra small reflector positioned for uplighting of low, narrow spaces
- Patterned glowing front shield also illuminates wall below
- Clear lens for safety and easy maintenance
- Through-wired continuous row or individually mounted

Performance

Two parabolic reflector sections drive light across the ceiling from one edge. An elliptical section redirects its light to a parabola and shields the lamp from normal viewing angles. Glare is minimized and asymmetry of the beam is maximized resulting in high beam efficiency and superior surface uniformity.

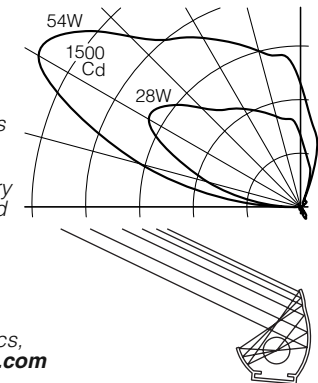

For complete photometrics, visit thelightingquotient.com

Finish:

Matte white housing, decorative front shield, and decorative end plates and reveal plates. Decorative illuminated front shield is available in three patterns and is lined with a frosted plastic diffuser, or choose a solid non-illuminated front shield. Custom patterns for front shield available, consult factory.

Painted surfaces – 6 stage pretreatment and electrostatically applied thermoset powder coat for stable, long lasting and corrosion resistant finish.

Reflector – extruded high purity aluminum with clear anodized specular finish. All luminaire hardware – stainless steel.

Mounting:

Mounting plate fastens flush to wall. Housing hinges on plate for hands free access to wiring.

Electrical:

Use 90°C wire for supply connections and through wire. 7/8" (22mm) diameter knockouts located at each end of mounting plate for conduit feed (by others).

Housing hinges down for access to ballast and wiring. Optional #12 AWG prewired modular through wiring with quick connectors.

Integral electronic HPF thermally protected class P ballast with end-of-life protection.

Optional electronic dimming ballast; compatible dimmer switch required (by others). Consult sales representative for compatibility and specifications.

Optional integral emergency battery operates one lamp. Separate unswitched supply is required.

Optional occupancy sensor with 50%/100% step dimming ballast.

Standard:

UL listed or CSA certified.



To form a Catalog Number

F | 1 | 4 | 7 | - | T | | | - | W | | | - | | | - | L | | | | |
 1 | 2 | 3 | 4 | 5 | 6 | 7 | 8 | 9

1 Source

F = Linear fluorescent

2 Style

147 = Xtra small enclosed wall mount upright (ADA compliant)

3 Lamp

T | | | = T5 Fluorescent Lamp Code

Lamp Wattage (see chart below)
 Configuration of Lamps, specify 1 or 3

Example: T128 = one 4' (1.22m) housing with one 28W T5 lamp

Reflector Configuration

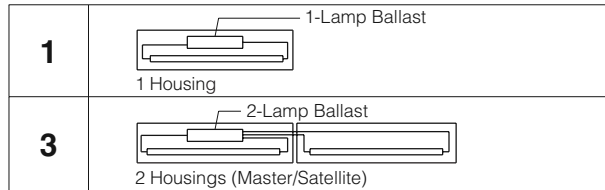

Lamp Wattage

Lamp Length (nominal)	Lamp Wattage (Lamp Number)	
	T5	T5 HO
2'	14 (F14T5)	24 (F24T5/HO)
3'	21 (F21T5)	39 (F39T5/HO)
4'	28 (F28T5)	55 (F54T5/HO)

For complete lamp and ballast information, see Accessories Section. Standard T5 lamp color is 3000K/80+ CRI.

4 Mounting

W = Wall mount

5 Shield Configuration

A = Illuminated design "A"

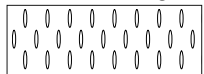

B = Illuminated design "B"

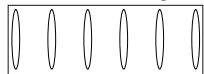

C = Illuminated design "C"

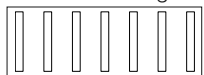

S = Non-illuminated design "S"



Project: _____

6 Finish

- 2 = Matte white
- 9 = Custom RAL or computer matched color to be specified, consult sales representative

7 Voltage/Ballast

- Electronic*
- 1 = 120V
 - 2 = 277V
 - 3 = 347V (Canada)
- Dimming**
- T = 120V
 - V = 277V

* Availability for wattages and voltages varies with ballast manufacturer and control type – see thelightingquotient.com for additional dimming specifications and limitations.

8 Option (See Accessories Section for specifications)

- L0 = No option
- LE = Integral emergency battery pack with indicator lamp and test button. Operates one lamp. Only available for lamp codes T128, T328, T155, and T355.
- LK = Prewired modular #12 AWG through wiring with quick connectors.
- LC = Combination of emergency battery pack and prewired modular through wiring as described above. Only available for lamp codes T128, T328, T155, and T355.
- LP = Passive infrared occupancy sensor to switch unit on/off or between high and low output with dimming ballast (consult factory for ballast options).
- LX = For modification not listed, include detailed description. Consult factory prior to specification.

9 Destination Requirement

- 0 = UL listed or CSA certified for U.S.
- J = UL listed or CSA certified for Canada

Example

F147 - T328 - W - B2 - 2 - LK0

Xtra small enclosed wall mount upright for use with two 4' F28T5 lamps. Two housings (master/satellite) are each 48" long, not including decorative end plates. Wall mount. Illuminated shield pattern B. Matte white finish. Integral 277V electronic ballast. Clear lens. Modular through-wiring with quick connectors. UL listed or CSA certified for U.S.

Order decorative end plates separately.

Type: _____

Accessories

Order separately. See Accessories Section for specifications.

- ADE47 | 0 = **Decorative end plates**, pair
 One set required for each row or single unit. Adds 1/4" (6mm) to length.
- 22 = Matte white
 - 99 = Custom RAL or computer matched color to be specified

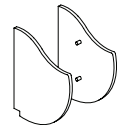

Options

Specify option codes in base fixture catalog number.

- LK Prewired modular through wiring with quick connectors.

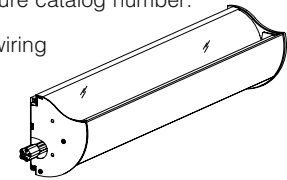

- LP Passive infrared occupancy sensor to switch unit on/off or between high and low output with dimming ballast (consult factory for ballast options).

