

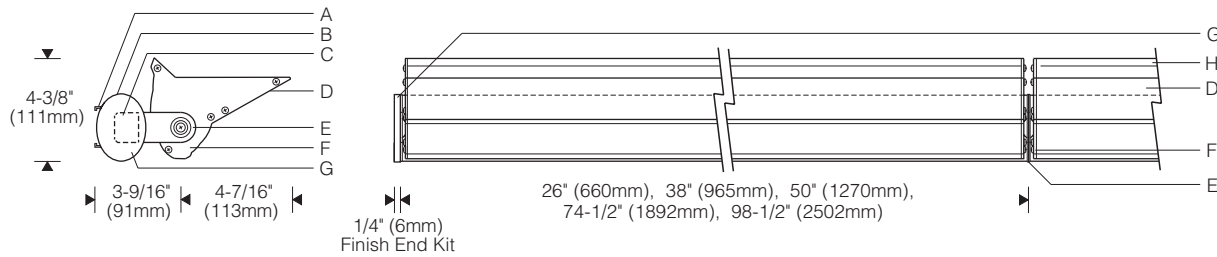

Wall Mount: 1:8 Scale

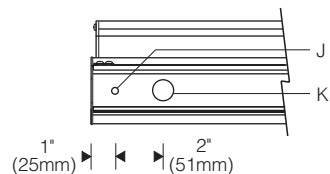

Mounting Plate



Installation

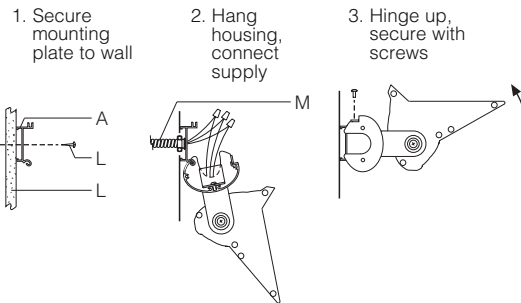

Base Mount

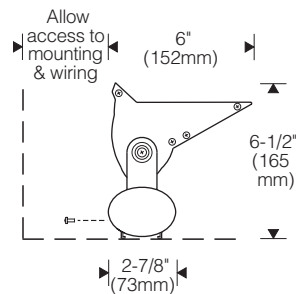

Specifications

- | | | | |
|--------------------------------------------|-----------------------------------------------------------------------|-----------------------------------------------|------------------------------------------------------|
| A Extruded aluminum mounting plate | E Aluminum sidearm | H Specular extruded aluminum reflector | L Support structure and fasteners (by others) |
| B Extruded aluminum ballast housing | F Contoured aluminum end plate | J Mounting hole, (3) 9/32" (7mm) dia. | M Conduit and connector (by others) |
| C Electronic ballast | G AFE finish end kit (aluminum end plates for ballast housing) | K Knockout, (2) 7/8" (22mm) dia. | |
| D Extruded aluminum visor | | | |

Features

- **KO Series** for cost and energy conscious projects
- Adjustable reflector with T8 lamp – creates a broad luminous of plane light for diffuse, glare-free illumination
- Classic oval-shaped ballast housing – hinges on wall plate for easy installation; through wiring for continuous rows
- Optional modular wiring, dimming, emergency battery

Performance

Two parabolic reflector sections drive light across the ceiling from one edge. An elliptical section shields the lamp from normal viewing angles and redirects its light to a parabola. Glare is minimized and asymmetry of the beam is maximized resulting in high beam efficiency and superior surface uniformity.

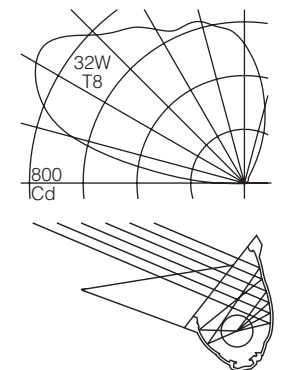

For complete photometrics, visit thelightingquotient.com

Finish:

Semi-gloss white housing and end plates or bright clear anodized aluminum reflector with semi-gloss black end plates, sidearms, visor and ballast housing.

Painted surfaces – 6 stage pretreatment and electrostatically applied thermoset powder coat for stable, long lasting and corrosion resistant finish.

Reflector – extruded high purity aluminum with clear anodized specular finish. All luminaire hardware – stainless steel.

Mounting:

Mounting plate fastens flush to wall. Unit hinges on plate for hands-free access to wiring.

Electrical:

Use 90°C wire for supply connections and through wire. 7/8" (22mm) dia. knockouts at ends of mounting plate for conduit feed (by others). Accessory end feed kit provides entry for surface conduit at end of ballast housing.

Housing hinges down for access to ballast and wiring. Optional #12 AWG prewired modular through wiring with quick connectors.

Integral electronic HPF thermally protected class P ballast.

Optional electronic dimming ballast dims to 5% of full light output. Compatible dimmer switch is required (by others). Consult local sales representative for specifications.

Optional integral emergency battery operates one lamp. Separate unswitched supply is required.

Standard:

UL listed or CSA certified for damp locations (Style 151 painted model with gasketed lens recommended for damp location use; see Outdoor section).



To form a Catalog Number

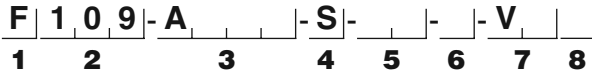

1 Source

F = Linear fluorescent

2 Style

109 = Small KO Series contoured, integral ballast

3 Lamp

A | | | = T8 Fluorescent Lamp Code

Lamp Wattage (see chart below)

Number of Lamps in Length, specify 1 or 2

Example: **A225** = one nominal 6' reflector with two 25W T8 lamps; one 2-lamp ballast

Lamp Code	Luminaire Length*	Lamp(s)
T8 Fluorescent		
A117	26" (661mm)	1 x F17T8
A125	38" (966mm)	1 x F25T8
A132	50" (1270mm)	1 x F32T8
A225	74-1/2" (1893mm)	2 x F25T8
A232	98-1/2" (2502mm)	2 x F32T8

For complete lamp and ballast information, see Accessories Section. T8 lamp not included.

*Add 1/2" (13mm) to row or single unit for **AFE** Finish End Kit.

4 Mounting

S = Wall (or base) mount

5 Finish

02 = Semi-gloss white

81 = Bright clear anodized reflector with semi-gloss black visor, end plates, side arms and ballast housing

99 = Custom RAL or computer matched color to be specified, consult sales representative

Project: _____

Type: _____

6 Voltage/Ballast

Electronic

1 = 120V

2 = 277V

3 = 347V (Canada)

Dimming*

T = 120V

V = 277V

7 Option (see Accessories Section for specifications)

VO = Cutoff visor included, no other option

VE = Integral emergency battery pack with indicator lamp and test button (not available for **A117** lamp code). Operates one lamp.

VK = Prewired modular #12 AWG through wiring with quick connectors

VC = Combination of emergency battery pack and prewired modular through wiring as described above

VX = For modification not listed, include detailed description. Consult factory prior to specification.

Note: Cutoff visor included with all options.

8 Destination Requirement

0 = UL listed or CSA certified for U.S.

J = UL listed or CSA certified for Canada

Example

F109 - A225 - S - 02 - 1 - VK0

Small KO Series contoured model for use with two 3' F25T8 lamps, 74-1/2" long housing (not including **AFE** finish end kit, order separately). Wall mount. Semi-gloss white. Integral 120V electronic ballast. Cutoff visor. Prewired modular through wiring with quick connectors. UL listed or CSA certified for U.S.

Accessories

Order separately. See Accessories Section for specifications.

AFE09 | | | **0** = **Finish end kit**, one required for each row or single unit. Adds 1/2" (13mm) to length.

02 = White

08 = Black



ASC06000 = **End feed kit**, bracket with 7/8" dia. entry to secure surface conduit



AFK000X | | | = **Ballast fuse kit**

0 = U.S.

J = Canada

