

**S Mount** 1:8 Scale

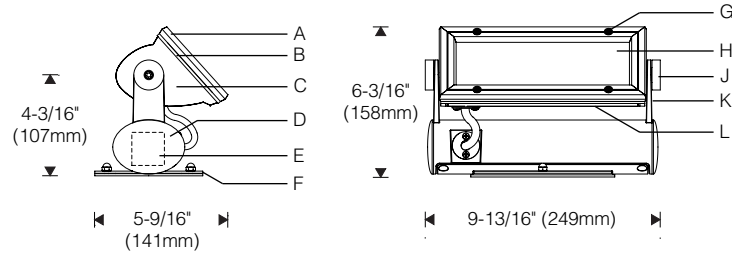

**Mounting Plate**

(S Mount)

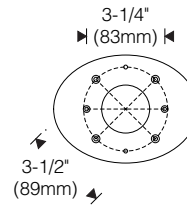

For use with surface, recessed, round, or rectangular outdoor outlet box by others

**Cantilever: Lighting Downward**

(for use with X Mount)

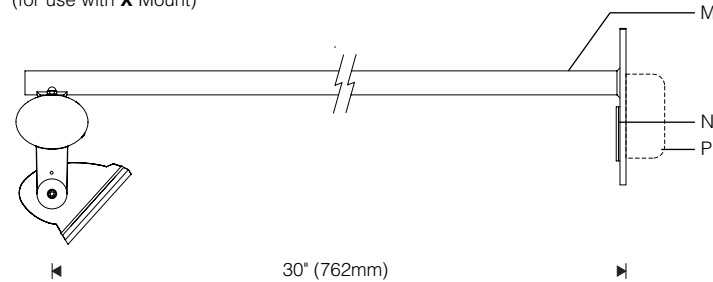

**Cantilever Mounting Plate**

(X Mount)

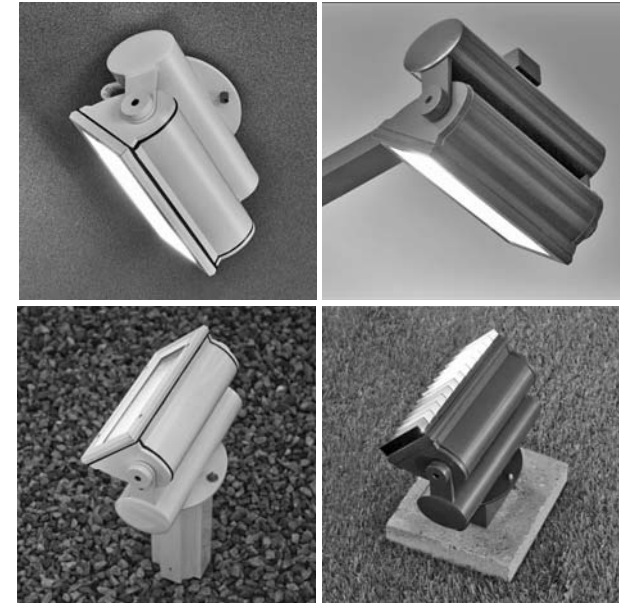
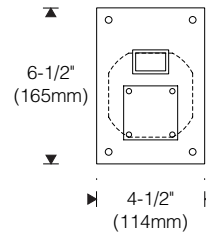

**Specifications**

- A** Mitred extruded aluminum door frame
- B** Precured silicone door and lens gasket
- C** Die-cast aluminum end plates
- D** Die-cast aluminum ballast housing and side arms
- E** Integral electronic ballast
- F** Stainless steel canopy, mounting plate, cap nuts
- G** Tamper-resistant captive door screws
- H** Microprismatic tempered glass lens
- J** Aluminum decorative knobs
- K** Locking set screw
- L** Specular extruded aluminum reflector
- M** 1" x 1-1/2" aluminum arm
- N** Welded aluminum mounting plate with splice access cover
- P** Recessed outlet box (by others)

**Finish:**

Exterior surfaces – 6 stage pretreatment and electrostatically applied thermoset polyester powder coating for a durable abrasion, fade and corrosion resistant finish. Choice of semi-gloss colors (see ordering information).

Reflector – extruded high purity aluminum with clear anodized specular finish. All hardware and components – non-corrosive stainless steel or aluminum. Door secured with captive tamper-resistant (#10 Torx) screws in stainless steel threaded reflector inserts to prevent seizing. Yoke attaches with recessed hex socket screws.

**Mounting:**

Stainless steel mounting plate compatible with most recessed and surface mounted wet-location outlet boxes (outlet box by others). Stainless steel oval canopy attaches to mounting plate with stainless steel hardware.

Aluminum cantilever or slipfitter mounting assemblies ordered separately; specify X mount. Suitable backing structure required.

**Electrical:**

Use 90°C wire for supply connections. Leads exit reflector and enter ballast housing through watertight flush cord entry and silicone coated fiberglass sleeving.

**S** mount – provided with 8" (0.2m) leads exposed for supply connections at recessed or surface outlet box.

**X** mount – provided with 60" (1524mm) leads exposed for slipfitter mounting or cantilever mounting over recessed outlet box.

G12 lampholder for use with single ended lamp.

Integral electronic HPF ballast offers improved voltage regulation and color stability. Automatic shutoff feature eliminates end-of-life lamp cycling.

For complete ballast specifications, see Accessories Section.

**Standard:**

UL listed or CSA certified for wet locations.

**Features**

- Energy-efficient wall lighting – scaled for walls 8' to 12' high
- Compact yet powerful – up to 70W ceramic metal halide
- Ceramic metal halide – warm color, high CRI, long life
- Integral electronic ballast – precise lamp regulation
- Surface, cantilever, or slipfitter mounting options for up/down orientations

**Performance**

Two parabolic reflector sections drive light up (or down) the vertical plane from one edge. An elliptical section redirects its light to a parabola and shields the lamp. Asymmetry is maximized resulting in high beam efficiency and superior surface uniformity. The fast "runback" minimizes glare and spill light. Wide lateral distribution permits greater spacings.

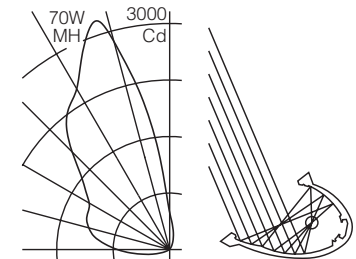

For complete photometrics, visit [thelightingquotient.com](http://thelightingquotient.com)



