

End View 1:3 Scale

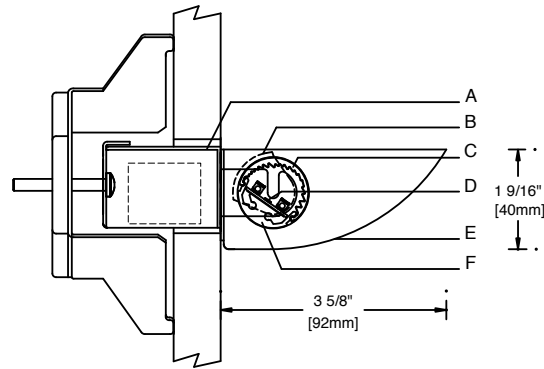

Front View 1:4 Scale

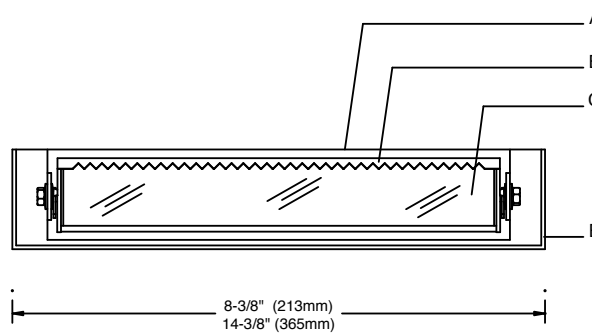

Rough Opening Dimensions

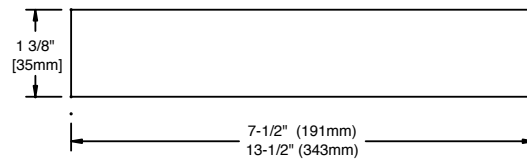

Rear View of Recessed Driver Box 1:3 Scale

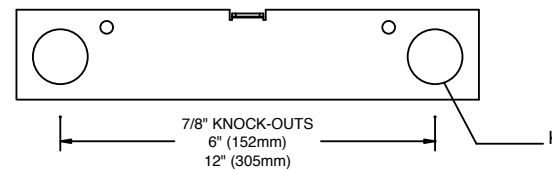

S413-M028 "A"

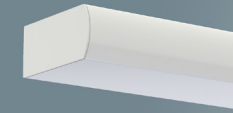

S413-M028 "C"

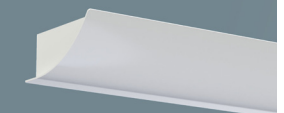

S413-M028 "J"

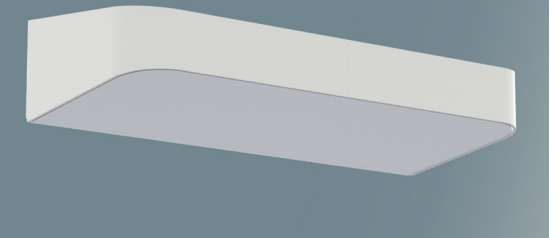

Specifications

- | | | | |
|--|--|---|-------------------------------|
| A Formed aluminum wall plate | D Aluminum core LED board | G Formed aluminum driver box and cover | K 7/8" dia. knock-outs |
| B Optional adjustable backsplash shield | E Formed steel enclosure (aluminum for MRI) | H High power factor electronic LED driver | |
| C Extruded semi-diffuse asymmetric lens | F Extruded aluminum heat sink | J Adjustable and lockable optical assembly | |

Optic Assembly:

Extruded aluminum heat sink. Exterior heat sink anodized for maximum emissivity. Precision extruded polymer refractive lens with optimal diffusion. Aluminum core LED board with high efficiency dual-die midpower LEDs.

Finish:

Anodized extruded aluminum heat sink, aluminum reveal plates, cold rolled steel sconce enclosure finished semi-gloss white (or specified color).

Painted surfaces – 6 stage pretreatment and electrostatically applied thermoset polyester powder coating for a durable abrasion, fade and corrosion resistant finish.

All hardware – stainless steel.

Mounting:

Aluminum driver enclosure/mounting plate mounts into wall with brackets and hardware provided. Yoke arms support optical assembly allowing aiming to maximize ceiling uniformity.

Electrical:

Provided with integral HPF electronic driver. (2) 7/8" knock-outs in rear allow for feed-through wiring.

Optional dimming drivers available, compatible dimming controls (by others). See [MA-1303](#) for dimming compatibility.

Standard:

CSA certified for dry locations. 5 year warranty, maximum ambient temperature 45°C (113°F).

Features

- Crisp geometric sconce enclosures compliment any space or design your own housing
- Fully adjustable and lockable aiming
- Optional adjustable sawtooth backsplash shield to minimum back light
- ADA compliant - less than 4" projection from wall.



Performance

Precisely extruded acrylic lens produces an asymmetric distribution ideal for illuminating ceiling surfaces evenly.

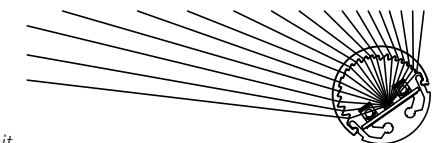
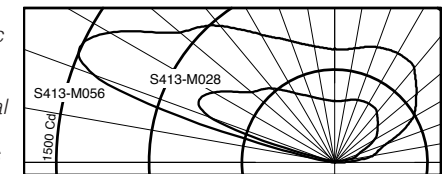

For complete photometrics, visit thelightingquotient.com



To form a Catalog Number

Project: _____

Type: _____

S | 4 | 1 | 3 | - | | - | | - | | - | | - | | - | | - | | - | | - |

1 2 3 4 5 6 7 8 9 10

1 Style

S413 = Xtra-small Ensonce® in-wall with integral driver

2 Output / Power



S = Standard output
H = High output

3 Length

08 = 8 inch (10W standard output or 16W high output)
14 = 14 inch (16W standard or 32W high output)

See [Scaled Performance Table](#)

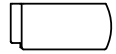
4 Enclosure

A = Rectangular with crescent front	C = Curved scoop	J = Tapered front with round edges
		

Additional designs or custom designs available, consult factory

5 Finish

02 = Semigloss white **13** = Matte Black* **22** = Matte White*
06 = Dark bronze* **15** = Metallic* **PL** = Platinum*
07 = Silver* **17** = Champagne* **99** = Custom or RAL, consult rep.*
08 = Semigloss black **18** = Copper* consult rep.*

02	22*	PL*	07*	15*
08	13*	06*	18*	17*

* = non-cancellable/returnable

6 Voltage

M = 120-277V Universal voltage input



7 Option

00 = No options
0S = Sawtooth edge backsplash shield
0M = For use in MRI suite (S414 remote only, MRI filters by others)

8 Destination Requirement

0 = CSA certified for U.S.
J = CSA certified for Canada

9 Color Temperature / CRI

927 = 2700K, 90+ CRI **TWH*** = Tunable White 
930 = 3000K, 90+ CRI 2700K-6500K 90+CRI
935 = 3500K, 90+ CRI **RGB*** = Color tunable 
940 = 4000K, 90+ CRI RGBW with 3500K, 90+ CRI white

See Style S414 for Tunable White or RGBW
Note: Additional CCT and CRI options are available; consult factory.

10 Dimming

00 = Non-dimming
ZX = 0-10V analog dimming 120-277V or 347V input, dimming 100%-1%, 0-10V controls by others
TD = ERP forward or reverse phase 120V only, dimming 100%-6%, 120V phase controls by others

Controls

AWB-TP-DMX-0 = RGBW LED dimmer switch fits in a standard wall switch box and provides on/off control as well as fixed levels of dimmability. The dimmer switch has a color-selection wheel for thousands of color options, 10 dynamic color-changing/single color modes, 0-100% dimming, on/off controls, and 4 color-specific channel controls for red, green, blue, and white.



Additional Wired and wireless controls available, see [Driver and Controls Information](#)

