

**Style S531** 1:3 Scale

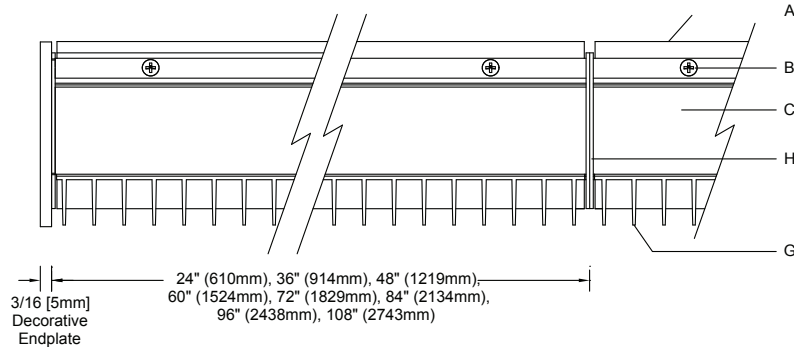

**Top View** 1:4 Scale, H Mount

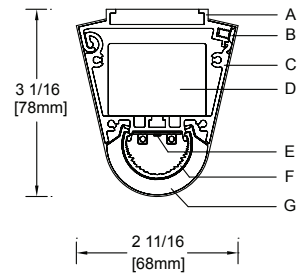
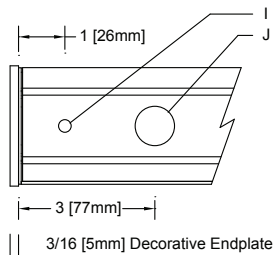

**Surface Mount** 1:2 Scale

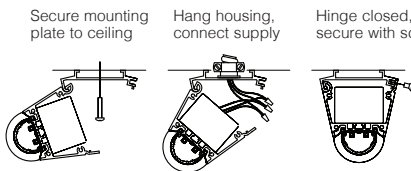

**Cable Mount** 1:16 Scale

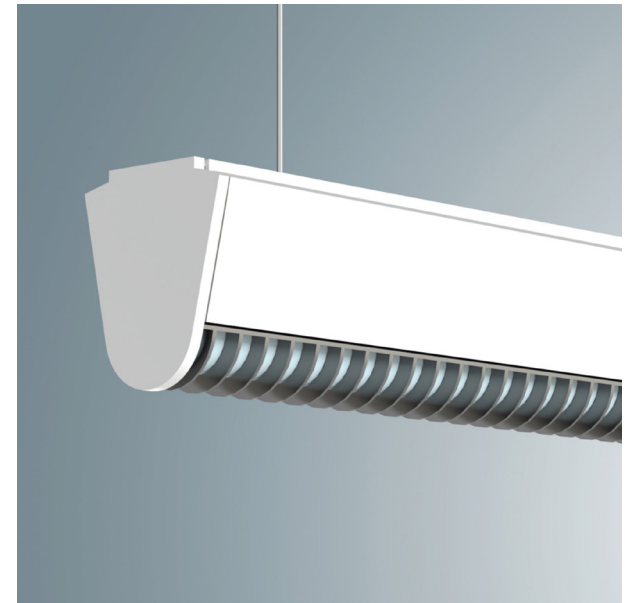
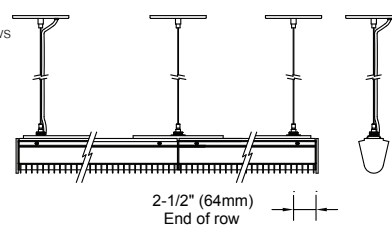

**Specifications**

- |                                    |  |   |                                      |
|------------------------------------|--|---|--------------------------------------|
| 6 Extruded aluminum mounting plate | 9 High efficiency constant current electronic driver | < Polycarbonate cross baffle              | ? Knockout, (2) 7/8" (22mm) diameter |
| 7 Closure screws                   | : LED light engine                                   | = Aluminum reveal plate                   |                                      |
| 8 Extruded aluminum housing        | ; Bi-Asymmetric optic                                | > Mounting hole, (3) 9/32" (7mm) diameter |                                      |

**Features**

- Compact size with integral driver
- Bi-asymmetric distribution – evenly light both sides of aisle



**Performance**

Precisely extruded acrylic lens produces a bi-asymmetric distribution ideal for illuminating both vertical surfaces in grocery aisles, library stack aisles, archives or computer server farms.

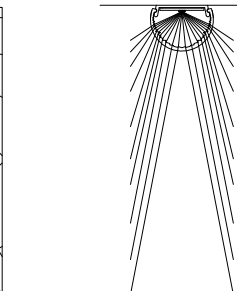
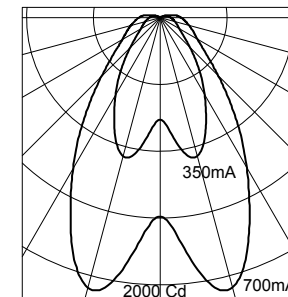

L90(10k) > 60,000 hrs.  
@ 25°C per TM-21

For complete photometrics, visit [thelightingquotient.com](http://thelightingquotient.com)



