

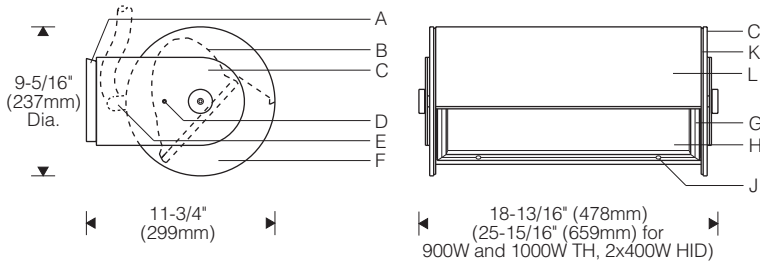

**Style 153** (Halogen, H.I.D. remote) 1:12 Scale

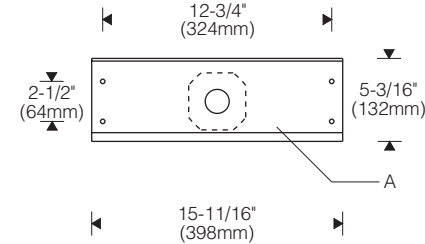

**Mounting Plate**



**Style 154** (H.I.D. integral) 1:12 Scale

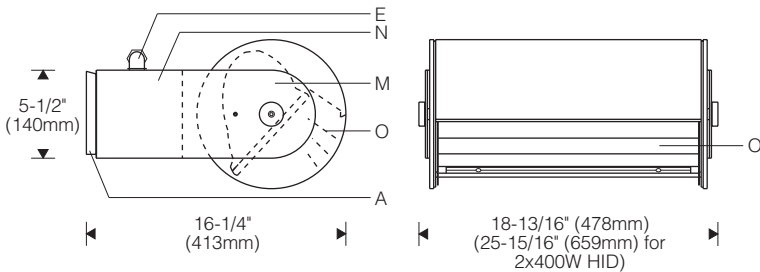

**Installation**

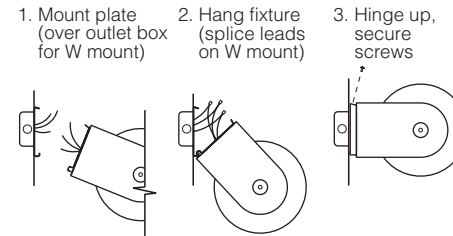

**Specifications**

- |   |   |  |  |
|---|---|--|--|
| <b>A</b> Stainless steel latch/hinge mounting plate (black) | <b>E</b> 3/8" liquidtight connector (S mount only, conduit by others) | <b>H</b> Clear, flat, thermal and impact resistant tempered glass lens | <b>L</b> Extruded aluminum cylindrical housing           |
| <b>B</b> Specular extruded aluminum reflector               | <b>F</b> 1/4" aluminum end plates                                     | <b>J</b> Tamper resistant captive door screws                          | <b>M</b> 3/16" aluminum side arms                        |
| <b>C</b> 3/16" aluminum yoke                                | <b>G</b> Mitred extruded aluminum door frame with silicone gasket     | <b>K</b> Reveal plates (black)   | <b>N</b> Extruded ballast housing                        |
| <b>D</b> Locking set screw                                  |   |  | <b>O</b> Optional horizontal radial blade baffle (black) |

**Finish:**

Exterior surfaces – 6 stage pretreatment and electrostatically applied thermoset polyester powder coating for a durable abrasion, fade and corrosion resistant finish. Choice of semi-gloss colors (see ordering information).

Reflector and internal end plates – extruded high purity aluminum with clear anodized specular finish. All hardware and components – non-corrosive stainless steel or aluminum. Door secured with captive tamper-resistant (#10 Torx) screws in stainless steel threaded reflector inserts to prevent seizing. Yoke/sidearms attach with recessed hex socket screws.

**Mounting:**

Stainless steel latch/hinge mounting plate; suitable backing structure required (by others).

**S** mount – wall or ceiling mounted for use with exposed liquidtight conduit (by others).

**W** mount – wall or ceiling mounted over recessed outlet box (by others). Luminaire hinges on mounting plate for hands-free access to splices.

**Electrical:**

Use 90°C wire for supply connections. **S** mount supplied with 5' (1.5m) leads exposed beyond 3/8" 90° liquidtight conduit connector (provided). **W** mount has 8" (.2m) leads.

Tungsten halogen (Style 153 only) – recessed single contact (RSC) lampholder in patented clamping supports for maximum heat dissipation.

Metal halide – Mogul lampholder is pulse rated for use with either horizontal or universal position reduced envelope pulse start lamps. End-of-lamp aligner ensures consistent optical performance, minimizes damage from shock or vibration. Ballast – remote HPF constant wattage autotransformer (CWA) or electronic each rated for -20°F/-29°C starting. Weatherproof aluminum enclosure (Style 153) includes three 7/8" dia. entries and one 3/8" liquidtight conduit connector. Optional remote ballast for dry indoor location.

For complete ballast specifications, see Accessories Section.

**Standard:**

UL listed or CSA certified for wet locations.

**Features**

- Rugged extruded aluminum cylinder with 1/4" end plates houses the rigid reflector – no exposed fasteners
- Thermal and impact resistant lens, precured silicone gaskets – seal out dirt and moisture, maintain performance
- Round end plates – consistent profile regardless of aiming
- Powerful – up to 1000W halogen, 2x400W metal halide

**Performance**

Two parabolic reflector sections drive light across the ground plane from one edge. An elliptical section redirects its light to a parabola and shields the lamp. Asymmetry is maximized resulting in high beam efficiency and superior surface uniformity. Fast "runback" minimizes wasted spill and trespass light. Wide lateral distribution permits greater spacings.

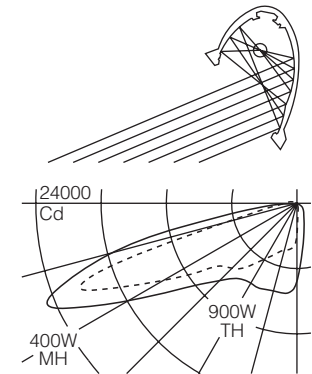

For complete photometrics, visit [thelightingquotient.com](http://thelightingquotient.com)



To form a Catalog Number

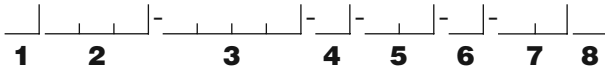

1 Source

M = Metal halide  
T = Tungsten halogen

2 Style

153 = Large outdoor cylinder, remote ballast  
**Note:** Available for tungsten halogen (no ballast) and metal halide.  
154 = Large outdoor cylinder, integral ballast  
**Note:** Available for metal halide.

3 Lamp

| Lamp Code   | Wattage | Lamp Number       | Voltages | Remote Distance |
|---|---------|-------------------|----------|-----------------|
| Ceramic Arc Tube Pulse Start Metal Halide (90+ CRI) |         |                   |          |                 |
| 210C  | 210     | CDM210/T9/930/U/E | 2, U     | 30' (9m)        |
| 315C  | 315     | CDM315/T9/930/U/E | 2, U     | 30' (9m)        |

| Lamp Code  | Wattage | Lamp Number        | Voltages     | Remote Distance         |
|--|---------|--------------------|--------------|-------------------------|
| Ceramic Arc Tube Pulse Start Metal Halide (80+ CRI)* |         |                    |              |                         |
| 150G   | 150     | CDM150/T6/830      | 1, 2<br>T, U | 15' (4.5m)<br>5' (1.5m) |
| 250C   | 250     | CMH250/U/830/R     | A, B         | 50' (15m)               |
| 400C   | 400     | CMH400/U/830/R     | A, B         | 50' (15m)               |
| 240C   | 2x400   | (2) CMH400/U/830/R | A, B         | 50' (15m)               |

| Lamp Code  | Wattage | Lamp Number              | Voltages     | Remote Distance         |
|--|---------|--------------------------|--------------|-------------------------|
| Quartz Arc Tube Pulse Start Metal Halide (68 CRI)* |         |                          |              |                         |
| 250P   | 250     | MS 250W/H75/T15/PS/740   | A, B<br>2, U | 50' (15m)<br>16' (4.8m) |
| 320P   | 320     | MS 320W/H75/T15/S/PS/740 | A, B<br>2, U | 50' (15m)<br>16' (4.8m) |
| 350P   | 350     | MS 350W/H75/T15/PS/740   | A, B<br>2, U | 50' (15m)<br>16' (4.8m) |

| Lamp Code        | Wattage | Lamp Number   | Voltages | Remote Distance |
|------------------|---------|---------------|----------|-----------------|
| Tungsten Halogen |         |               |          |                 |
| 0300             | 300     | Q300T3        | A        |                 |
| 0350             | 350     | Q350T3/CL/HIR | A        |                 |
| 0500             | 500     | Q500T3        | A        |                 |
| 0900             | 900     | Q900T3/CL/HIR | B, G     |                 |
| 1000             | 1000    | Q1000T3       | F, G     |                 |

For complete lamp and ballast information, see Accessories Section.  
\* Use only clear metal halide horizontal or universal position lamp with compact envelope. Standard lamp colors are 3000K for Ceramic Arc Tube Pulse Start lamps and 4000K for Quartz Arc Tube Pulse Start Metal Halide lamps.

Project: \_\_\_\_\_

4 Mounting

W = Latch/hinge mounting plate fastens over recessed outlet box. Ceiling or wall mounting.  
S = Latch/hinge mounting plate for wall or ceiling. For use with exposed liquidtight conduit (by others).

5 Finish

02 = Semi-gloss white  
06 = Dark bronze  
07 = Silver  
08 = Semi-gloss black  
12 = Green  
99 = Custom RAL or computer matched color to be specified, consult sales representative.

6 Voltage/Ballast

Electronic (Metal Halide only):  
1 = 120V  
2 = 277V  
T = 120V dim\*  
U = 208-277V dim\*  
Magnetic and Tungsten Halogen:  
A = 120V  
B = 277V  
F = 220V (TH)  
G = 240V (TH)

\*100-50% dimming, 0-10V compatible controls by others. Consult factory for dimming the 210W lamp.

7 Option (see Accessories Section for specifications)

00 = No options  
0B = Internal horizontal radial blade baffle, matte black. Provides horizontal cutoff of lens brightness when maximum candlepower is aimed 55° above nadir.  
0R = Halogen standby lamp with relay. Relay is field connected at remote ballast for Style 153, integral for Style 154. Lamp included (wattage varies). Not available for 2x400W.  
TL = Micro-prismatic tempered glass lens (replaces clear, flat lens, offers smoother light pattern at reduced peak candlepower).  
XX = For modification not listed, include detailed description. Consult factory prior to specification.

8 Destination Requirement

0 = UL listed or CSA certified for U.S.  
J = UL listed or CSA certified for Canada

Example

M153 - 400C - W - 02 - B - 0B0

Large outdoor cylinder for use with 400 watt ceramic arc tube pulse start metal halide lamp. Latch/hinge mounting plate for recessed outlet box (by others). Semi-gloss white powder coat finish. Remote 277V ballast. Horizontal radial blade baffle. UL listed or CSA certified for U.S.

Type: \_\_\_\_\_

Accessories

Order separately. See Accessories Section for specifications.

AE  V  OD0 = External vertical blade baffle, black, for lengthwise shielding (not for use in combination with 0B baffle option)  
2 = 25° shielding  
4 = 45°  
D = 300W-500W TH; 150W-400W MH  
F = 900W and 1000W TH; 2x400W MH

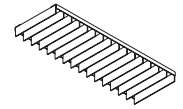

AFK000X  = Ballast fuse kit  
0 = U.S.  
J = Canada

